

Using Digital Assessment Tools in Competence by Design ...and beyond

Michele Farrugia, PD

Lisa St. Amant, PGME

Anand Lakhani, PGY1



Obstetrics & Gynaecology
UNIVERSITY OF TORONTO

Objectives

- **When** and **How** to use our digital assessment tools
 - Elentra
 - DOC



Which When?

- Elentra
 - University wide
 - For EPA assessment
 - CBD residents only
 - PGY-1 (and PGY-2)
 - UTorID
- DOC
 - Our department only
 - DEEF
 - O-Score
 - Case Log
 - Any PGY



Adding a Digital tool to your handheld device

1. Scan QR Code



Aim your camera here
to go to **Elentra**



Obstetrics & Gynaecology
UNIVERSITY OF TORONTO

Non-completion of assessments

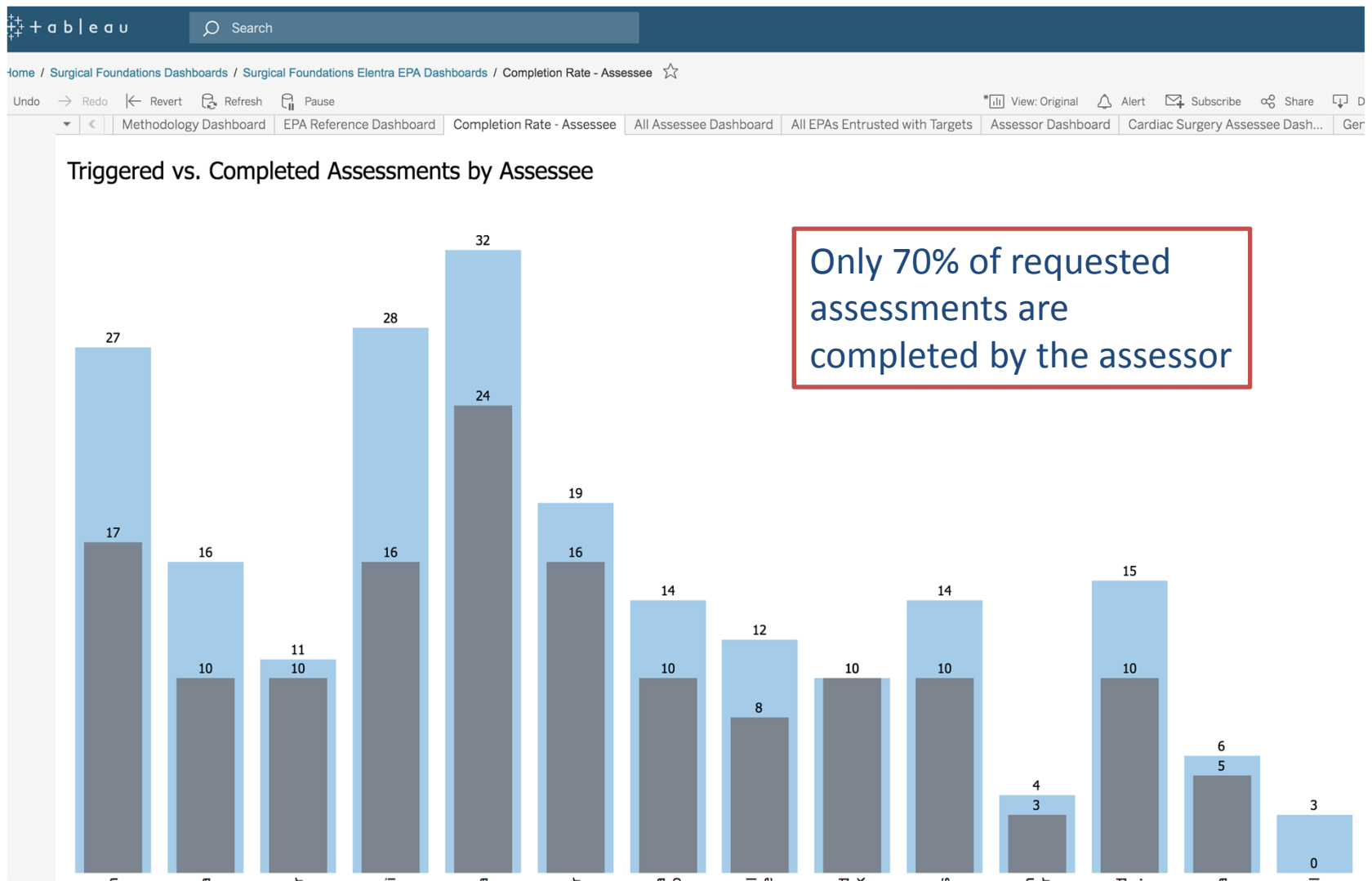

Elentra Tip....

- Tableau allows us to identify faculty who are asked for an assessment but do not complete/submit one....



[HOME](#) [TASKS & RESULTS](#) [START ASSESSMENT](#)

/ Student Dashboard

Obstetrics & Gynecology

All

Stages

Assessments

Pins

^ **Transition to Discipline** CBD Learner Assessment Schedule

D501 Performing the preoperative preparation of patients for basic surgical procedures

0 Assessments

D502 Recognizing and initiating early management for critically ill surgical patients

0 Assessments

D503 Documenting clinical encounters

0 Assessments

D504 Demonstrating handover technique

0 Assessments

7



HOME TASKS & RESULTS START ASSESSMENT

Obstetrics & Gynecology

Stages

Assessments

Pins

FILTER OPTIONS

Search

Select Assessor



Reset

Apply Filters

Completed

In Progress

Pending

Deleted

Completed Assessments

Assessment & Pre-Op Planning

Feb 12, 2019

Multiple Assessment Form

F503



ENTRUSTMENT



8

/ My Assessments / Start Assessment

Select Assessor

Farrugia, Michele (mfarrugia@mtsina.on.ca) 

 Add Assessor

Select Program

Obstetrics & Gynecology 

Select Date of Encounter

2019-04-08 

Select Assessment Method

- ☒ **Complete now**
Complete the assessment now on this device. The assessor will receive a confirmation email upon submission.
- ☐ **Complete and confirm via email**
Complete an assessment using the selected tool. Upon completion, the assessor will receive an email notification asking them to review/edit and confirm the assessment.
- ☐ **Email blank form**
The assessor will receive an email notification to complete an assessment based on the selected tool.

Stage of Residency

F: Foundations of Discipline 

Assessment tool

Assessment & Pre-Op Planning ✕

Start Assessment

Complete the assessment now on this device. The assessor will receive a confirmation email upon submission.



Assessor

Michele Farrugia

Faculty • ObsGyn • ObsGyn

mfarrugia@mtsinai.on.ca



Assessee

Anand Lakhani

PGY1 • Obstetrics & Gynecology

anand.lakhani@mail.utoronto.ca

F503: Assessing and performing risk optimization for preoperative patients in preparation for surgery

This tool assesses the following EPA

- EPA-FOD-SF-3: Assessing and performing risk optimization for preoperative patients in preparation for surgery

Demographics

Type of Assessor / Role

University appointed faculty



Type of Assessment

Direct observation



Rotation Service

Core Ob/Gyn



Site

MSH



Assessment

Completed by assessor

- Indicate the rating that best applies
- **NOTE: If unable to assess, indicate NO RATING**

Performs focused clinical assessments with recommendations that are well-documented



Selects and/or interprets approp investigations and/or imaging w sufficient attention to clinical details



Develops and implements plans for pre-op optimization of patients



Uses appropriate prophylaxis (eg antibiotics, PE prophylaxis)

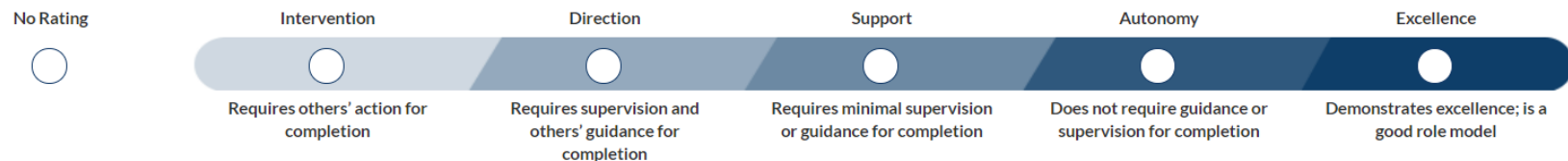

Considers urgency and potential for deterioration, in advocating for timely execution of a procedure or therapy

Incorporates disease prevention, health promotion & health surveillance into interactions w pts



Indicate the **OVERALL** entrustment in this EPA at this time

Entrustment of this professional activity implies that the resident demonstrated an autonomous performance of the activity/task in a safe and effective manner at this time

Assessing and performing risk optimization for preoperative patients in preparation for surgery

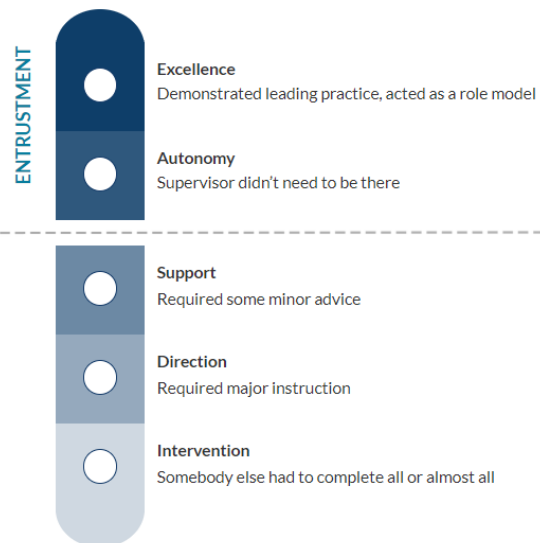

Feedback & Comments

Describe 2-3 strengths and actions or areas for improvement

2 - 3 Strengths

2 - 3 Actions or areas for improvement

Other comments



Save as draft & email assessor a link

Submit



Tasks & Results Dashboard

Assessment Tasks

Tasks Completed on Me

My Completed Tasks

My Learners

Faculty

Search Tasks...



Delivery Start



Delivery End



+ Apply Filters

✕ Remove Filters

Assessment Tasks

You currently have no Assessments to complete.

Adding a Digital tool to your handheld device

2. Upload website

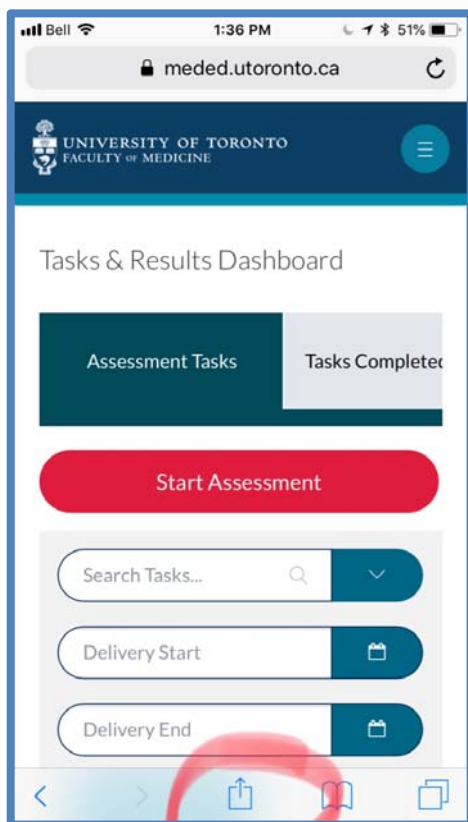

3. Add to homescreen

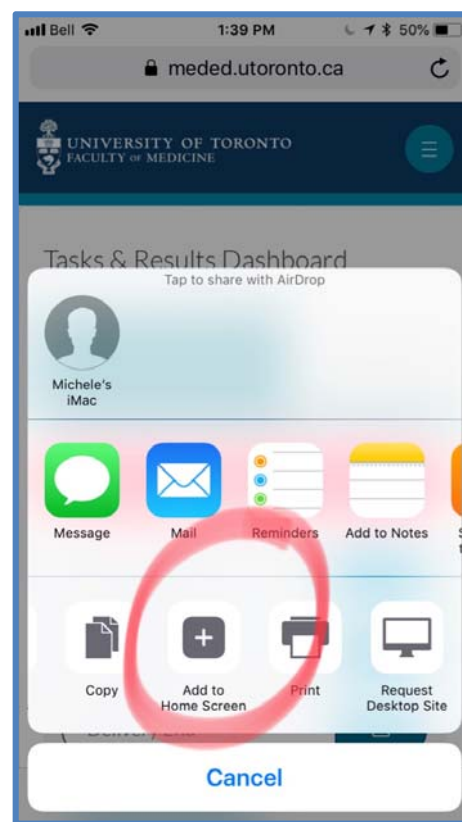

4. Logo on homescreen

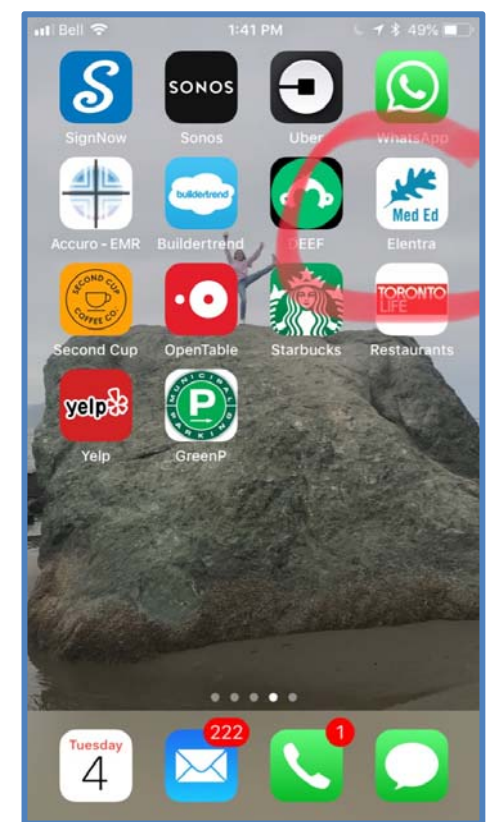

Introducing DOC



Obstetrics & Gynaecology
UNIVERSITY OF TORONTO

DOCs (version Feb26 2019)

HELP! What's an O-Score?

<https://www.dropbox.com/s/qv5g2ftkwcu6n5u/OSCORE.pdf?dl=0>

* Required

1. Which form would you like to submit? *

- ☐ Case log to track my procedures
- ☐ DEEF to assess a non-technical encounter
- ☐ O-Score to assess a technical skill

Updated DEEF
O-Score
Case Log

Submit

Never give out your password. [Report Abuse](#)

DOC

- Ideally
 - Resident asks assessor ahead of time
 - Part of coaching! Establish goals.....
 - Verbal feedback provided and form completed immediately after an encounter
 - Completed on resident's device
 - Can be emailed to faculty member too
 - Faculty can also initiate on their own device
 - Results collated at 123 Edward St. and provided to faculty supervisors and residents



DEEF

- To assess non-technical skills
- Narrative comments provide residents with the most information that allows them to learn and improve
- Intended to be FORMATIVE
- Low stakes assessment



1. Which form would you like to submit? *

- ☐ Case log to track my procedures
- ☒ DEEF to assess a non-technical encounter
- ☐ O-Score to assess a technical skill

2. Date of encounter *

3. PGY-Level *

- ☒ 1
- ☐ 2
- ☐ 3
- ☐ 4
- ☐ 5

4. Select a PGY1 resident from the list below *

6. What did you observe the resident doing? *

- ☐ Preconception/antenatal care
- ☐ OB Triage
- ☐ Management of labour
- ☐ Managing intrapartum complication
- ☐ Routine postpartum care
- ☐ Complex postpartum care
- ☐ Management of OB emergency
- ☐ Early pregnancy concern
- ☐ Common GYN office concern (e.g., fibroids, AUB)
- ☐ Contraception

- ☐ Early pregnancy concern
- ☐ Common GYN office concern (e.g., fibroids, AUB)
- ☐ Contraception
- ☐ Menopause
- ☐ Prolapse/incontinence
- ☐ Infertility
- ☐ Chronic pelvic pain
- ☐ Diagnosis/triage GYN neoplasm
- ☐ Post-op complications
- ☐ Other

5. Supervisor (Last, First) *

Farrugia, Michele

6. What did you observe the resident doing? *

OB Triage

7. Rate the resident's overall performance *

- ☒ 1. Intervention - requires others' action
- ☐ 2. Direction - requires supervision and others' guidance
- ☐ 3. Support - requires minimal supervision or guidance
- ☐ 4. Autonomy - does not require guidance or supervision
- ☐ 5. Excellence - demonstrates excellence; is a good role model

Entrustment scale

8. Feedback

Discuss the resident's strengths/weaknesses/suggestions for improvement. Try to comment on several CanMEDS Roles, as appropriate.

Enter your answer

Lots of narrative!

O-Scores

- Tool to assess surgical competency
- Simple to understand and use
- Widely used in surgical specialties
- In our context, intended to be FORMATIVE and low stakes



The Ottawa Surgical Competency Operating Room Evaluation (O-SCORE): A Tool to Assess Surgical Competence

Wade T. Gofton, MD, MEd, FRCSC, Nancy L. Dudek, MD, MEd, FRCPC,
Timothy J. Wood, PhD, Fady Balaa, MD, MEd, FRCSC, and Stanley J. Hamstra, PhD

Acad Med 2012

Abstract

Purpose

Most assessment of surgical trainees is based on measures of knowledge, with limited evaluation of their competence to actually perform various surgical procedures. In this study, the authors evaluated a tool they designed to assess a trainee's competence to perform an entire surgical procedure independently, regardless of procedure type or postgraduate year (PGY).

Method

In phase 1, the Ottawa Surgical Competency Operating Room Evaluation (O-SCORE) was piloted in the University of Ottawa's Division of Orthopaedic

Surgery. In phase 2, the refined 11-item tool (8 items rated on a 5-point competency scale, 1 item assessing procedural competence, 2 feedback items) was used in the Divisions of Orthopaedic Surgery and General Surgery to assess residents' performance on 11 common procedures. Quantitative and qualitative analyses were conducted.

Results

In phase 2, 34 orthopaedic and general surgeons assessed the performance of 37 residents in 163 procedures. ANOVA demonstrated an effect of PGY. Post hoc analysis found that total procedure scores for PGYs 1 and 2 were lower than

those for PGY 3 ($P < .001$), and PGY 3 scores were lower than those for PGYs 4 and 5 ($P < .02$). Analysis of qualitative data indicated that the rating scale was practical and useful for surgeons and residents.

Conclusions

This novel evaluation tool successfully discriminated between junior and senior residents and identified surgical competency across various PGY levels regardless of procedure type. Multiple sources of evidence support the O-SCORE as a valid tool for the assessment of trainee operative competency.



1. Which form would you like to submit? *

- ☐ Case log to track my procedures
- ☐ DEEF to assess a non-technical encounter
- ☒ O-Score to assess a technical skill

2. Date of procedure *

Please input date in format of M/d/yyyy



3. PGY-Level *

- ☐ 1
- ☐ 2
- ☐ 3
- ☐ 4
- ☐ 5

5. Supervisor (Last, First) *

Farrugia, Michele

6. Gyne Office Procedures

Select your answer



7. Hysteroscopy

Select your answer



8. Laparoscopic Surgery

Select your answer



9. Abdominal Surgery

Select your answer



10. Vaginal Surgery

14. Procedure complexity *

- ☐ Low
- ☐ Medium
- ☐ High

15. Rate the resident's performance *

- 1 - Intervention (requires others' actions for completion)
- 2 - Direction (requires supervision and others' guidance for completion)
- 3 - Support (requires minimal supervision or guidance for completion)
- 4 - Autonomy (does not require guidance or supervision for completion)
- 5 - Excellence (demonstrates excellence; is a good role model)

Entrustment scale

| | N/A | 1 | 2 | 3 | 4 | 5 |
|-----------------------|-----------------------|-----------------------|-----------------------|-----------------------|-----------------------|-----------------------|
| Pre-op Plan | <input type="radio"/> | <input type="radio"/> | <input type="radio"/> | <input type="radio"/> | <input type="radio"/> | <input type="radio"/> |
| Case Preparation | <input type="radio"/> | <input type="radio"/> | <input type="radio"/> | <input type="radio"/> | <input type="radio"/> | <input type="radio"/> |
| Knowledge of Steps | <input type="radio"/> | <input type="radio"/> | <input type="radio"/> | <input type="radio"/> | <input type="radio"/> | <input type="radio"/> |
| Technical Performance | <input type="radio"/> | <input type="radio"/> | <input type="radio"/> | <input type="radio"/> | <input type="radio"/> | <input type="radio"/> |
| Visuospatial Skill | <input type="radio"/> | <input type="radio"/> | <input type="radio"/> | <input type="radio"/> | <input type="radio"/> | <input type="radio"/> |
| Efficiency and Flow | <input type="radio"/> | <input type="radio"/> | <input type="radio"/> | <input type="radio"/> | <input type="radio"/> | <input type="radio"/> |
| Communication in OR | <input type="radio"/> | <input type="radio"/> | <input type="radio"/> | <input type="radio"/> | <input type="radio"/> | <input type="radio"/> |
| Post-op Plan | <input type="radio"/> | <input type="radio"/> | <input type="radio"/> | <input type="radio"/> | <input type="radio"/> | <input type="radio"/> |

16. Is the resident able to perform this procedure independently? *

☐ Yes

☐ No

17. Who initiated this assessment? *

☐ The resident

☐ The faculty

18. Feedback

Discuss the resident's strengths/weaknesses/suggestions for improvement. Try to comment on several CanMEDS Roles, as appropriate

Enter your answer

Narrative is very helpful

Submit

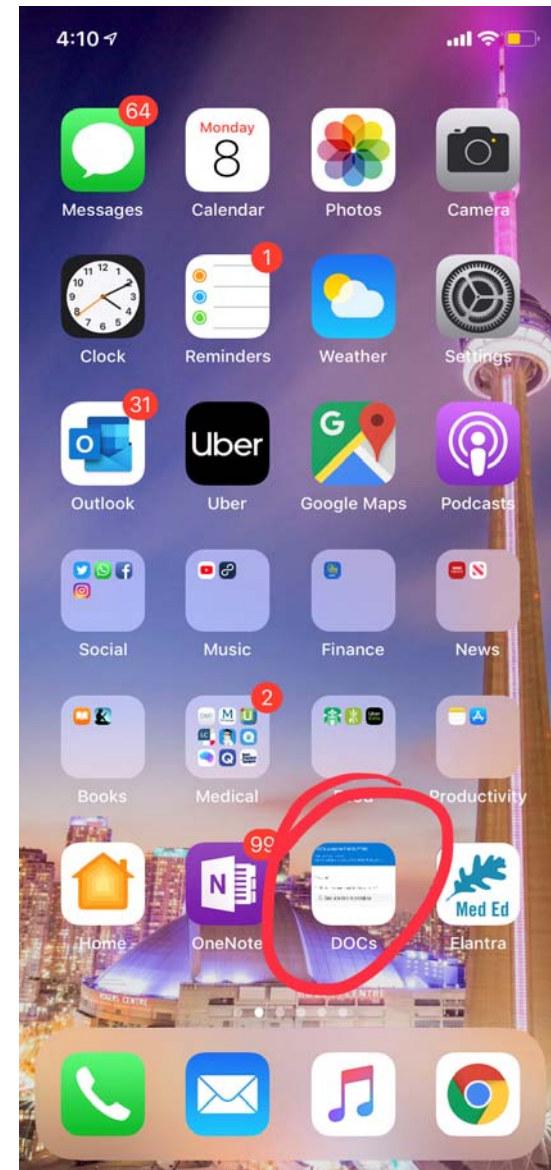
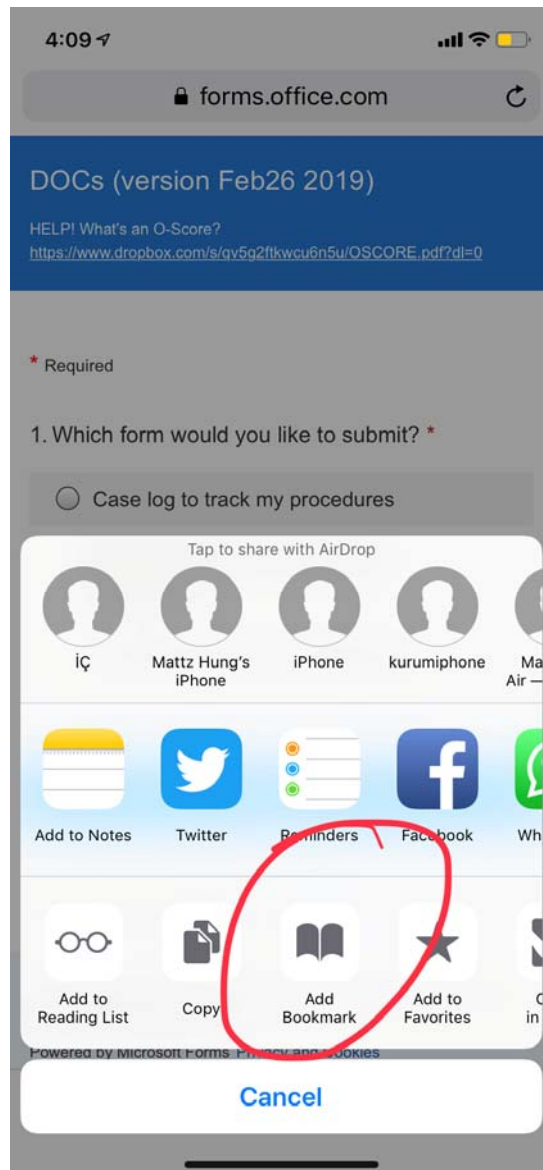

Conclusions

- Please use Elentra and DOC to document meaningful feedback to our residents





Obstetrics & Gynaecology
UNIVERSITY OF TORONTO